

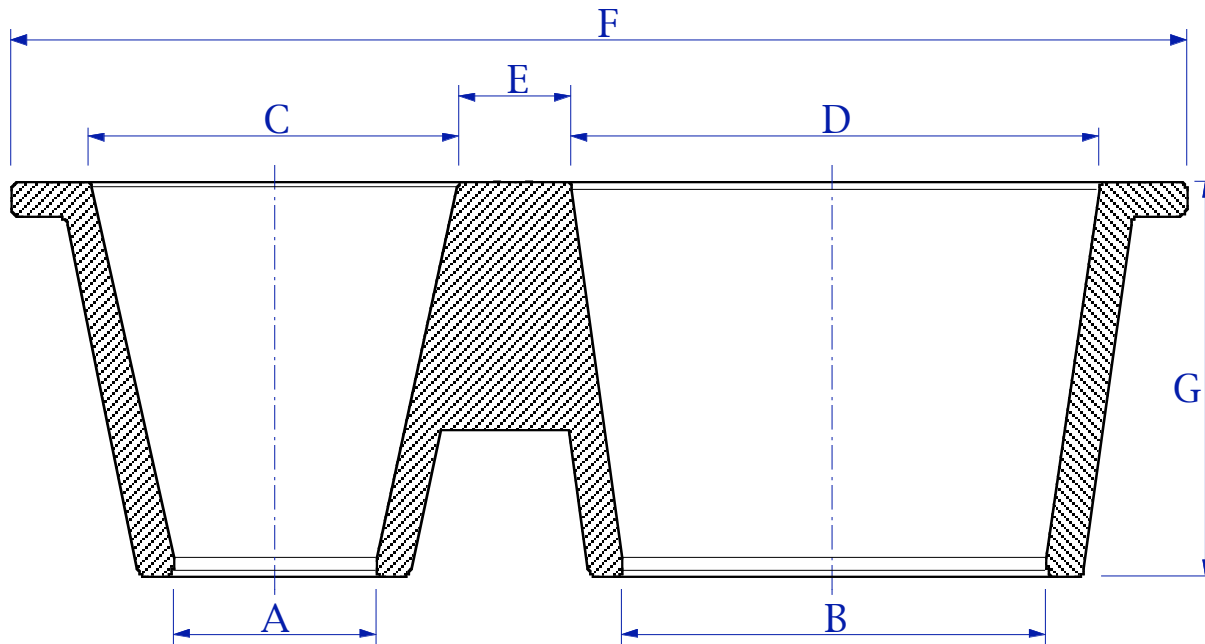

INDUSTRIAL CERAMIC PRODUCTS, INC.

Double Cups

ICP ceramic double cups are a beneficial component used in the manufacture of quality investment castings. The double cup design helps reduce re-oxidation inclusions by allowing air to escape through up sprue during casting. These cups are made from proprietary mullite or fused silica compositions compatible with investment mold materials. Samples are available upon request.



	A	B	C	D	E	F	G
#100 Double Cup	1.00"	2.00"	1 7/8"	2 7/8"	13/16"	7 1/8"	2 3/4"
#200 Double Cup	2.00"	2 7/8"	2 13/16"	3 1/2"	1.00"	8 1/4"	2 3/4"
#138 Double Cup	1 3/8"	2 7/8"	2 1/2"	3 1/2"	3/4"	8 1/8"	2 3/4"